

Some astute modifications have enabled the inhabitants of this home to linger much longer.

---

# SAY YOU'LL STAY

---

WORDS  
Alice LInes

PHOTOGRAPHY  
Simon Wilson





In Auckland, a sea view provides a compelling reason to stay right where you are, so when Nicole McKenzie and Dave Glackin decided they needed a change, it made sense not to move house but to update the one Nicole designed and built 10 years ago in the beachside suburb of Pt Chevalier. “We’ve always loved the orientation and fundamental floor plan of the house, and going through the process a second time allowed us to tweak the original design to enhance it for our family’s evolving needs,” says Nicole.

As director of Trinity Interior Design, Nicole lives and breathes interiors, so was well equipped to take the renovation process in her stride. However, she does confess to finding it far more difficult than designing for a client. “I’m exposed to so many products that the choices of what to specify for our own home were endless.”

To help her narrow down the options, the couple brought on board Trinity’s senior designer Jayne Tolley and architect Jason Bailey, who oversaw the structural changes that needed to be made. The key element in their brief was bringing the overall mood of the home up to date by creating warm and inviting spaces layered with tonal, textured finishes. >



**ABOVE LEFT** In the entryway, the patchwork of large-format slate tiles from Artedomus contrasts beautifully with the oak flooring. The artwork is by Jane Mason and the console table opposite it was custom-designed by Trinity Interior Design and made by Woodwrights. **ABOVE RIGHT** The kitchen’s oak veneer cabinetry by Central Joinery is finished with semi-matte Osmo Polyx-Oil and teamed with a Neolith Calacatta benchtop and splashback from SCE Stone & Design. Overhead is a pendant light by KKDC, and on the wall beside Nicole and Ollie (opposite) is a handcrafted basket from Collect Living.



## THE PROJECT

Trinity Interior Design director Nicole McKenzie and her sales director husband Dave Glackin renovated this four-bedroom home in Auckland’s Pt Chevalier for themselves and Dave’s children Josh (10) and Ollie (9).

**LIVING** A large corner sofa, coffee table designed by Trinity and Atlas Limestone rug by Armadillo & Co from The Ivy House create a spot for relaxing and socialising. A Root side table by Wendelbo from Bauhaus and a Yuh floor lamp by Louis Poulsen from Cult add elegant ebony accents to the earthy colour scheme that includes velvet and linen cushions by Trinity.





“We don’t like clutter or busy interiors, and a sense of simplicity without austerity is important to us,” says Nicole. “We like soft, organic tones that bring the outdoors in – timber, stone, slate, earthy greens and mustard.”

Although there were a few roadblocks at the beginning of the project, thanks in part to variations and amendments required by the council, Nicole forged ahead to allow plenty of time for the design process. She knew full well that locking in fixtures, fittings and finishes early on would enable the construction and install phases to run smoothly.

“I love the fact that the whole family was involved,” she says. “We’d all come through each week to see what had changed, and Dave and I talked Dave’s kids Josh and Ollie through what was going to happen next. They were as invested in the process as we were.”

The boys live with the couple part time and share a downstairs bedroom that now has a new ensuite. With direct access to the front courtyard and pool, it sees them downstairs for hours at a time, hanging out with their mates without disturbing the peace upstairs. Also downstairs is a serenely decorated bedroom affectionately known as ▷

**ABOVE** An oak-panelled partition divides the kitchen/dining and living areas; in the former is a solid-oak dining table designed by Trinity and made by Classique, with Tangerine chairs by Simon James. The framed work on the wall is a keepsake from Nicole’s travels in Africa, while the art in the living area is by Jane Mason. The Hug chair on the far right in this space is by Wendelbo from Bauhaus.



**TOP LEFT** An IC pendant by Michael Anastassiades adorns the bathroom, along with light grey mosaic strip tiles by Artedomus. **TOP RIGHT** Josh sits in the living area on a bench seat cushioned by Trinity squabs. The timber and shell-inlay vessels beside him are from Collect Living. **ABOVE** Nicole had this sofa reupholstered in Mississippi 19 fabric by Lizzo from Westbury Textiles. The lamp is designed by Trinity and made by Jimmy’s Handbuilt, the Crescent coffee tables are from King Living and the Ritz Luxe rug is from Source Mondial.



**TOP LEFT** White Maps tiles from European Ceramics line the walls in the downstairs bathroom, which has a chic recessed shelf above the Justina freestanding bath from Stonebath. The stool is from Soren Liv. **TOP RIGHT & ABOVE LEFT** The walls in the master bedroom are painted in Resene Half Atmosphere. The simple styling in this space includes an Isabella chair by Simon James and a Bjorn Oval mirror by Middle of Nowhere. **ABOVE RIGHT** The boys' ensuite features Cinca mosaic tiles from Artedomus, and a vanity custom-made with a S3 stone basin from Stonebath, a Caesarstone Fresh Concrete top and Laminex Sabia Rigato timber veneer panels.

**ABOVE** The twin beds in the kids' room have grooved-ply headboards that will slot together seamlessly if the room ever needs to be updated with a double bed. Bedding from Thread Design, blankets from Atelier Textiles and a Five pouf by Muuto from Bauhaus complete the look.

“Mum’s room” – a dedicated space that’s used by Nicole’s mother when she comes to stay and sits opposite a luxurious new bathroom.

The downstairs entry to the home is through a light-filled hallway with a double-height void. Slate flooring was installed here atop the existing polished concrete, and its grey through to black tones add some of that desired texture to this space.

But upstairs is where Nicole’s vision has really come into its own. Honey-toned oak floorboards extend throughout the living areas, and this same timber features on the panelled part-wall that cleverly divides the kitchen/dining and living areas, creating a sense of intimacy within the open-plan space. The kitchen’s timber cabinetry blends in seamlessly, framing a horizontal window above the bench for a lovely leafy outlook.

The exterior of the house has had a refresh too, and its striking cedar cladding and dark joinery make it appear for all the world like a brand-new home. “We just have the landscaping to finish, then we’re done for a while,” says Nicole. “It was a big seven months but we really enjoyed the process and the house now feels complete. It’s somewhere we can see ourselves living – and accommodating growing boys – for many years to come.”

**MASTER BEDROOM** This space is all the more inviting for the feature wall behind the bed made with Elitis Madagascar wallpaper from Seneca. It's combined with a headboard designed by Trinity and made by Siba Design, bed linen from Thread Design, throws from Siena Society and Stansborough, Seam drawer units by Simon James and Caravaggio lamps from Cult.



## DESIGN DETAILS

### CLOCKWISE FROM RIGHT

*Female Nude* framed artwork, \$500, achomestore.co.nz. Objects **candleholder** by Jaime Hayon for Fritz Hansen, \$404, cultdesign.co.nz. Hydrangea **cushion**, \$135, threaddesign.co.nz. Tangerine **stool** by Simon James, \$572, simonjamesdesign.com. Pepe **marble mirror** by Menu, \$920, partridgedesign.co.nz. Cesar **side table** by Minotti, \$2015, ecc.co.nz. Isabella **chair**, \$1557, simonjamesdesign.com. IC **pendant light** by Flos, \$1135, ecc.co.nz.

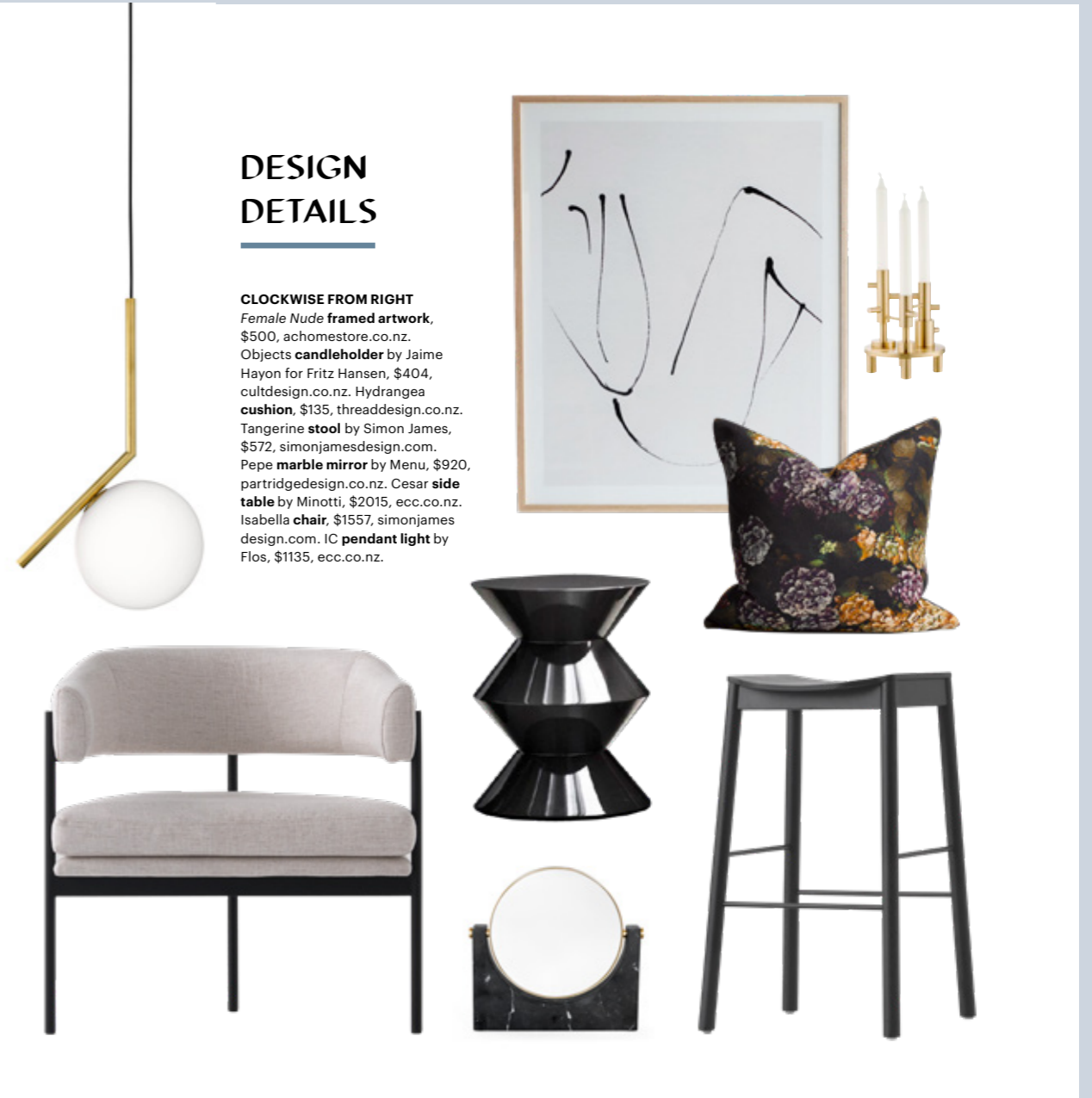

GROUND FLOOR

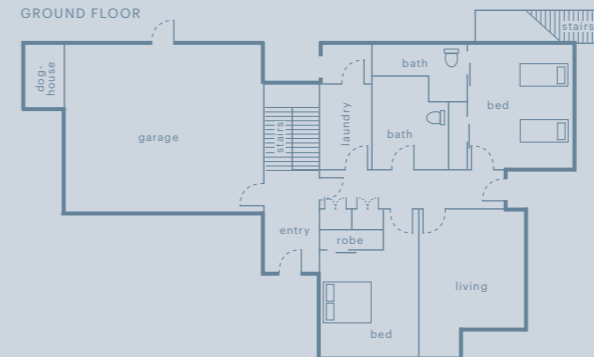

FIRST FLOOR

